

# HALL EFFECT CT 35mm Aperture (800A) HCT024

## DESCRIPTION

The Hall effect current sensor provides strong electrical isolation between the output of the sensor and the current carrying conductor. The output of the sensor reflects the real wave shape of DC, AC and pulsed currents of the primary circuit.

The aperture can be unclipped to fit over existing cables.



## General Specifications

Input Current:	+/- 800Adc depending on range ordered.
Measurement Output:	+/- 5Vdc
Response time $T_{90}$ :	10 $\mu$ S
Accuracy	1%
Linearity error:	< 0.4%
Offset voltage	$\pm$ 20mV
Hysteresis error	$\pm$ 10mV
Output impedance:	100 $\Omega$
Minimum output load:	8k2 $\Omega$
recommended output load:	$\geq$ 15k $\Omega$
Zero adjustment:	$\pm$ 2%
Span adjustment:	$\pm$ 20%
Temperature drift	$\leq$ 500ppm/ $^{\circ}$ C
Current consumption	$\leq$ 25mA
Power Supply:	$\pm$ 15Vdc $\pm$ 5% regulated
Isolation	3 kVrms / 50Hz / min
Overload:	16000A
Operating temperature range	-10 $^{\circ}$ C~+80 $^{\circ}$ C
Storage temperature range	-25 $^{\circ}$ C~85 $^{\circ}$ C
Fire redundancy	UL94-V0

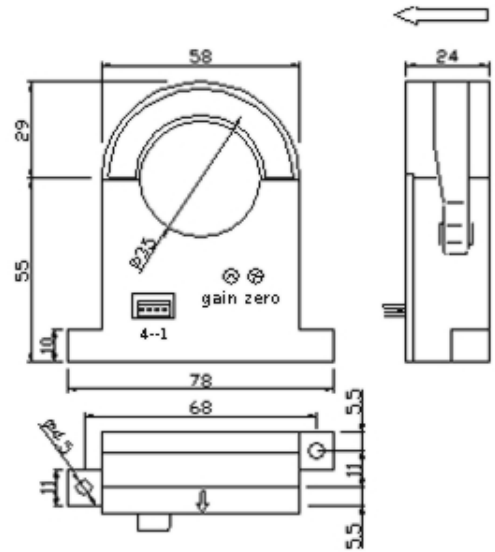

## Ordering Information

HCT024-800 = 800A input  
HCT024-400 = 400A input

## Application

The HCT024 is designed for use with the DCT247. The DCT247 is a din mounted signal conditioning module for monitoring of DC and true RMS AC currents and provides a standard process signal output or relay contact.

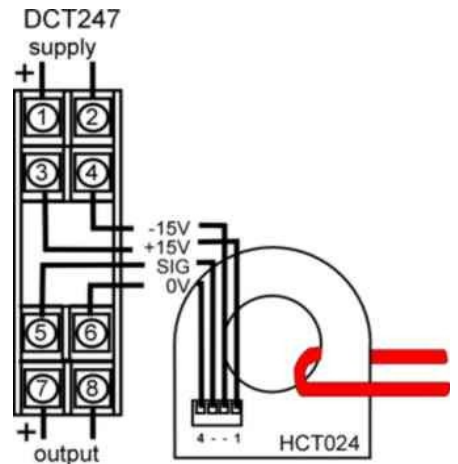

In the interest of development and improvement, APCS reserve the right to amend, without notice, details contained in this publication. APCS will accept no legal liability for any errors, omissions or amendments.